

QUOTE DATA SHEET

Model Number: A3RRA3

Date: 17 Aug 95

Customer:

Description: High Power Flange Termination

Electrical Specifications:

Frequency Range

: DC - 2.0 GHz

VSWR

: 1.10:1 max from 40 - 360 MHz

: 1.15:1 max from DC - 2.0 GHz

Input Power

: 250 WCW (-55 to +100°C; derate to 0 at +150°)

4 KW peak

Impedance

: 50 Ohms +/-2%

Temperature Coefficient

: +/-200ppm/°C

Material Specifications:

Resistive Element

: Proprietary Thin Film

Substrate

: Beryllium Oxide Ceramic

Cover

: Alumina Ceramic

Mounting Flange

: Copper, Nickel Plated per QQ-N-290

Tab Contact

: Beryllium Copper, Gold Plated per Mil-G-45204

Dimensions

: Per outline below

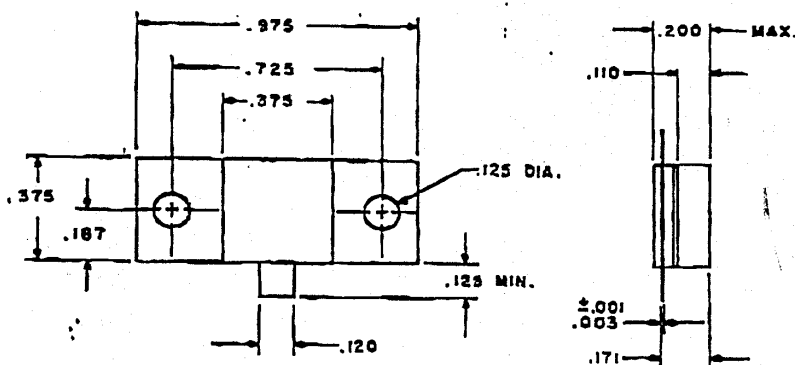
**KDI/triangle**

1st 50, -€
2nd 70, -€

0.50
TOTAL P.02